

# PowerPod Instructions

# PowerPod

## PACKAGE CONTENTS

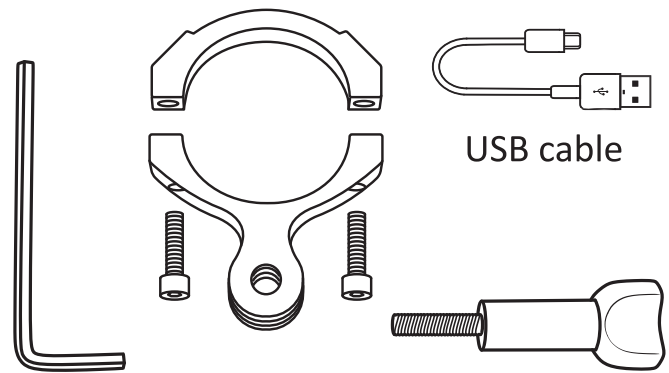
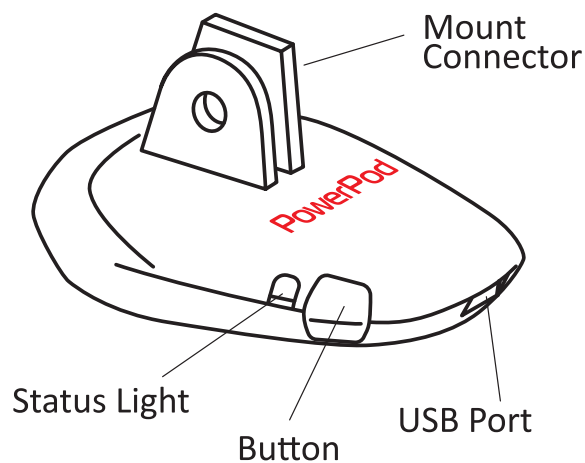

PowerPod mount and mounting hardware

## 1. Charge PowerPod

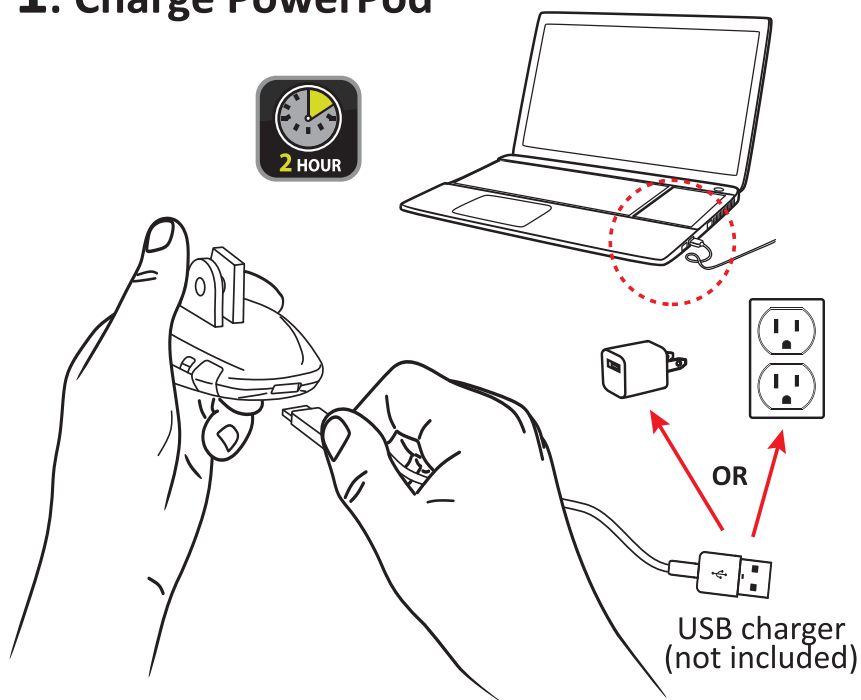

**1A** Flashes **RED** during charge

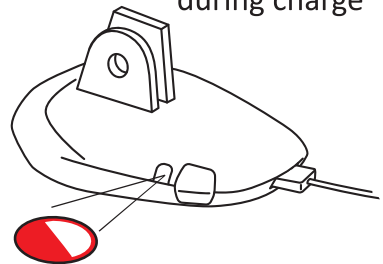

**1B** Light off fully charged

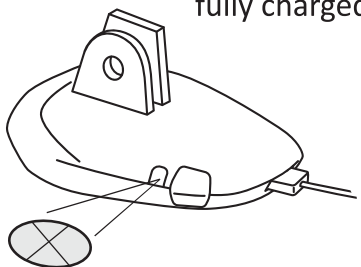

## 2. Attach mount to bike

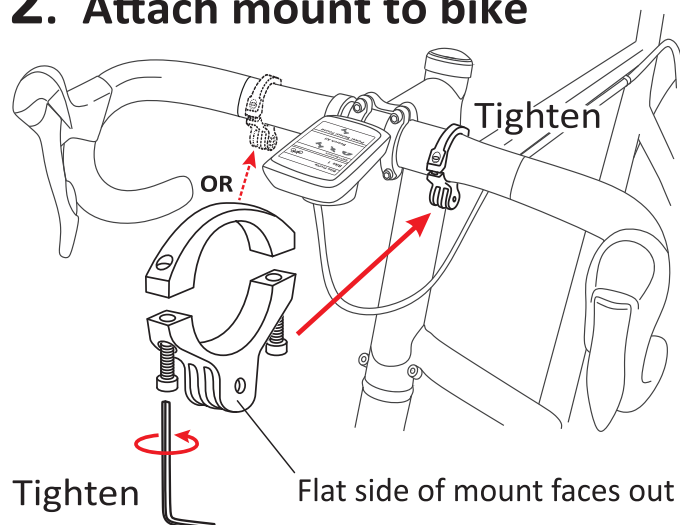

## 3. Attach PowerPod to mount

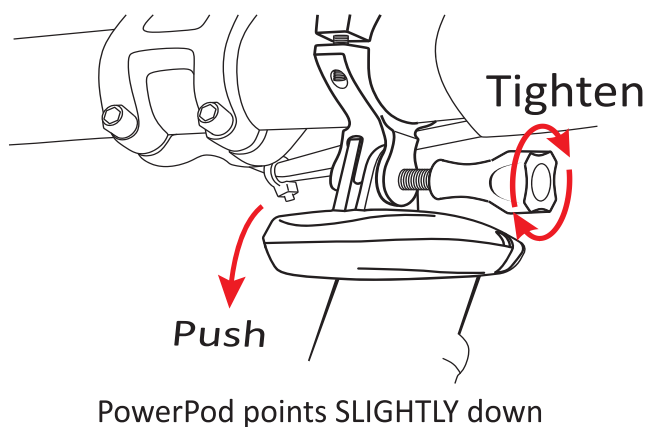

PowerPod points SLIGHTLY down

## 4. Pair PowerPod to ANT+ bike speed sensor

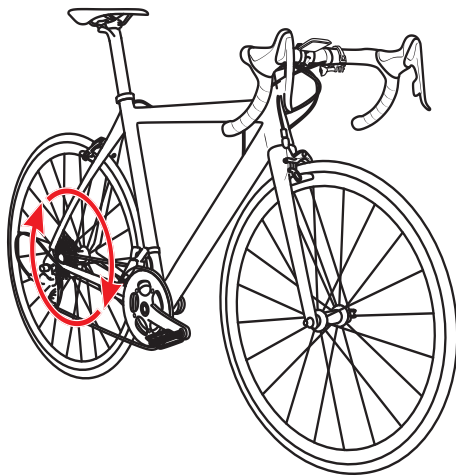

Spin sensor wheel  
to awaken speed sensor

4A



Press-hold button 4 sec. to pair

4B

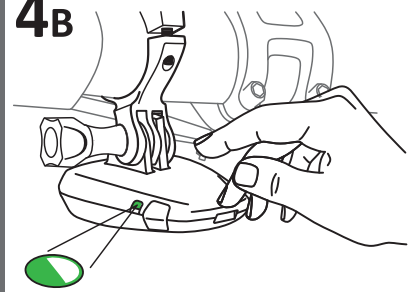

Release button  
when **FLASHING GREEN**

4C

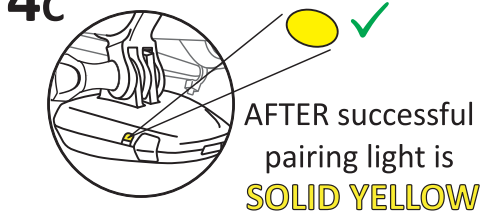

AFTER successful  
pairing light is  
**SOLID YELLOW**

4D

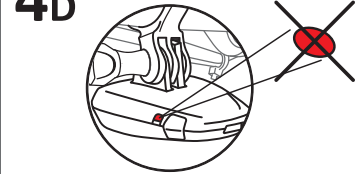

**RED:** pairing unsuccessful

## 5. Pair PowerPod to your ANT+ bike computer

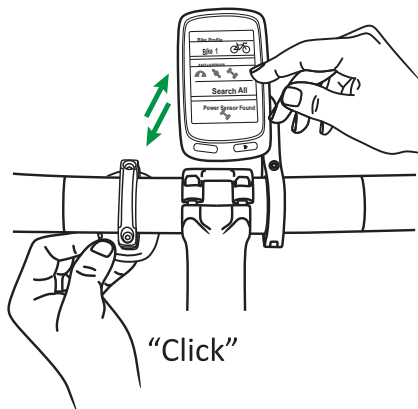

Refer to your ANT+ bike computer  
manual for pairing instructions

## 6. Calibrate

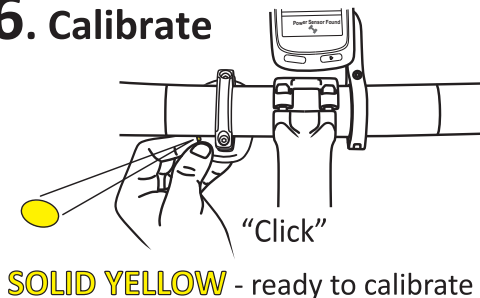

**SOLID YELLOW** - ready to calibrate

6A

Click to start  
calibration  
ride when  
flashing  
**RED/GREEN**

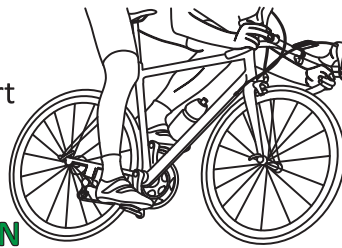

Refer to *O&B cal ride instructions sheet*

6B

Ride out: watts go  
from 1 to 50; STOP,  
and ride back to 100

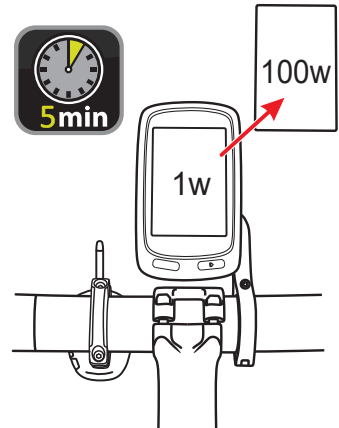

After calibration, actual  
power shown

## 7. Starting New Ride

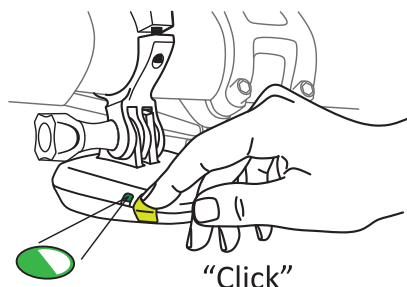

Light **FLASHES GREEN**

7A

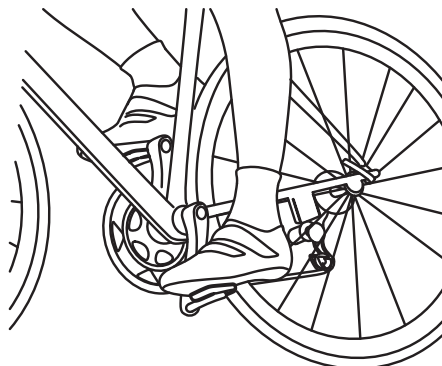

Spin wheel, light changes to  
**SOLID GREEN**

7B

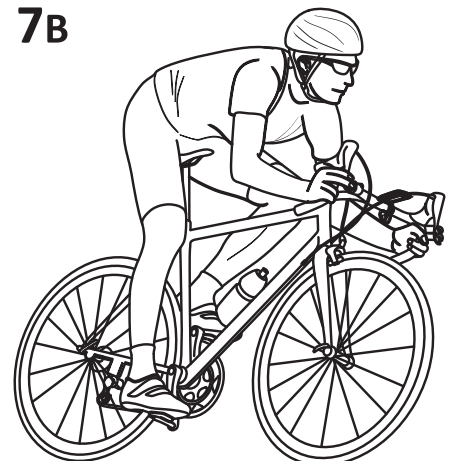

**GREEN MEANS GO!**