

## PACKAGE CONTENTS

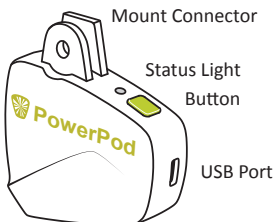

PowerPod Lite sensor

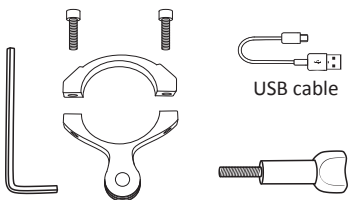

PowerPod mount and mounting hardware

## 1. Charge PowerPod

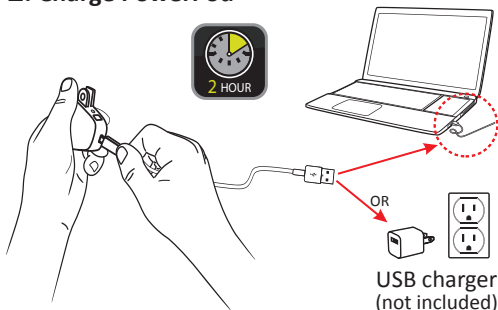

### 1A

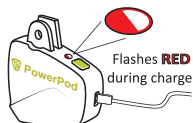

## 2. Attach mount to bike

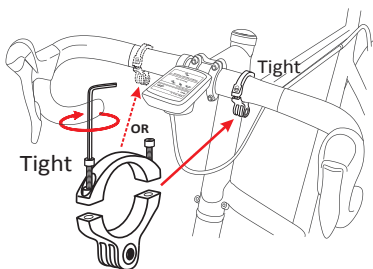

## 3. Attach PowerPod to mount

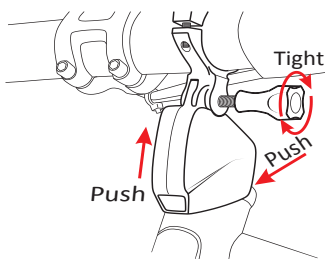

## 4. Pair PowerPod to ANT+ bike speed sensor

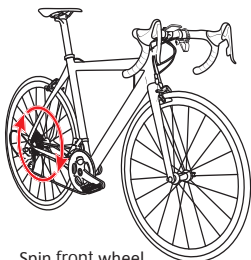

Spin front wheel  
to awaken speed sensor

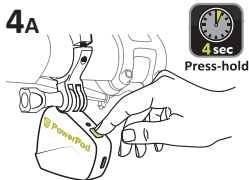
**4A**

Press-hold button 4 sec. to pair

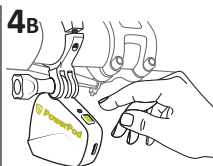
**4B**

Release button  
when **FLASHING GREEN**

**4C**

AFTER successful  
pairing light is  
**SOLID YELLOW**

**4D**

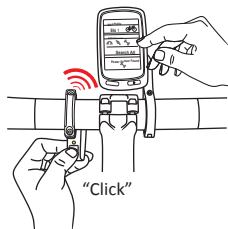

**RED:** Pairing unsuccessful

## 5. Pair PowerPod to your ANT+ bike computer

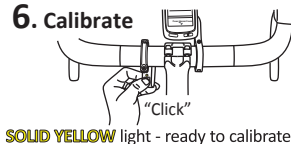

Refer to your ANT+ bike computer manual  
for pairing instructions

## 6. Calibrate



**SOLID YELLOW** light - ready to calibrate

**6A**

Flashing  
**red/green:**  
click to  
start  
O&B cal  
ride

Refer to O&B cal ride instructions sheet

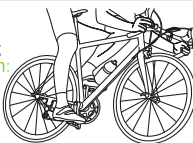

**6B**

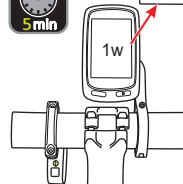
During out, watts go  
from 1 to 50;  
STOP, ride back  
to 100

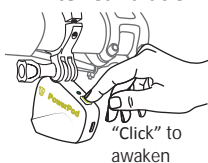

After O&B complete, actual  
power shown

## 7. After Calibration

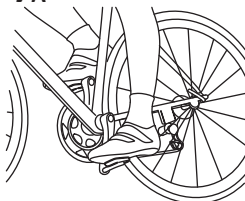

Light **FLASHES GREEN**

**7A**

Spin wheel, light changes to  
**SOLID GREEN**

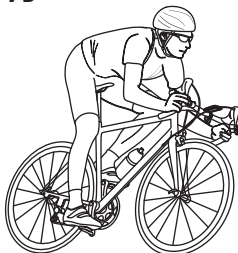
**7B**

**GREEN MEANS GO!**